

IberPrecis S.L.

VAST





To give the client a comprehensive solution, **Iber Preci S.L.** has the services of an external Engineering Company, an internal Laboratory Metrology and four internal main departments at its disposal. All areas are coordinated by the management of **Iber Preci S.L.** and guaranteed by more than 30 years of experience in precision machining and assembly of parts.

1. MAIN DEPARTMENTS:

Manufacturing department:

- Technical office specialised in development and design of routing and production process.
- Purchasing department for national and international purchases divided into purchasing of materials and subcontracting. It is important to single out this capacity to optimize costs and identify those components, we can not mechanise for price, capacity, strategy or delivery time constraints.
- Logistics department to coordinate our inventories, to fulfil confirmed delivery dates by considering scheduled dates with suppliers and manufacturing.
- The manufacturing area comprises 3 sections to deliver the finished component to the client:
- Machining with CNC centres (horizontal, vertical, multitask), as well as CNC lathes and grinding machines (max. size 700mm and diameter 500mm).
- Surface treatment through electro polishing, vibratory and blasting.
- Assembly of parts to ensure directly delivery to the client's production line.

Quality department to guarantee compliance with guidelines ISO 9001:2000 and EN-9100.

Sales department with an independent foreign commerce department.

Finance department to optimize financial resources.

2. LABORATORY METROLOGY (Business Partner of Zeiss)

We guarantee the dimensional control of our manufactured components through customer-specific data records. We assure these records with our qualified and AUKOM.e.V. – certified personnel (trained in coordinate metrology) and our machine park for metrology with special focus on:

- Measurement and analysis of interior and exterior structures of physical entities by x-ray technology (computed tomography).
- Tactile measuring with semiautomatic machine for measurement by coordinates (CMM with scanning technology).

3. ENGINEERING

To complete our value chain and to offer our clients an integrated solution we collaborate with a partner engineering company with 35 employees, which uses CATIA V5, PROENGINEER, UNIGRAPHICS, SOLIDWORK, SOLIDEDGE, INVENTOR AUTOCAD, ABAQUS, MSC LAMINATE, ADAMS, DYTRAN, LS-DYNA, NASTRAN-PATRAN software. Our partner specialises in:

- Engineering of static, dynamic, lineal and no lineal calculation through FEM. Assay of validation and instrumentation.
- Product engineering: Design and development of mechanical projects, design in plastic and composite material.
- Manufacturing engineering: Design and manufacturing of tools, machines, assembly lines, calibres for control, etc.



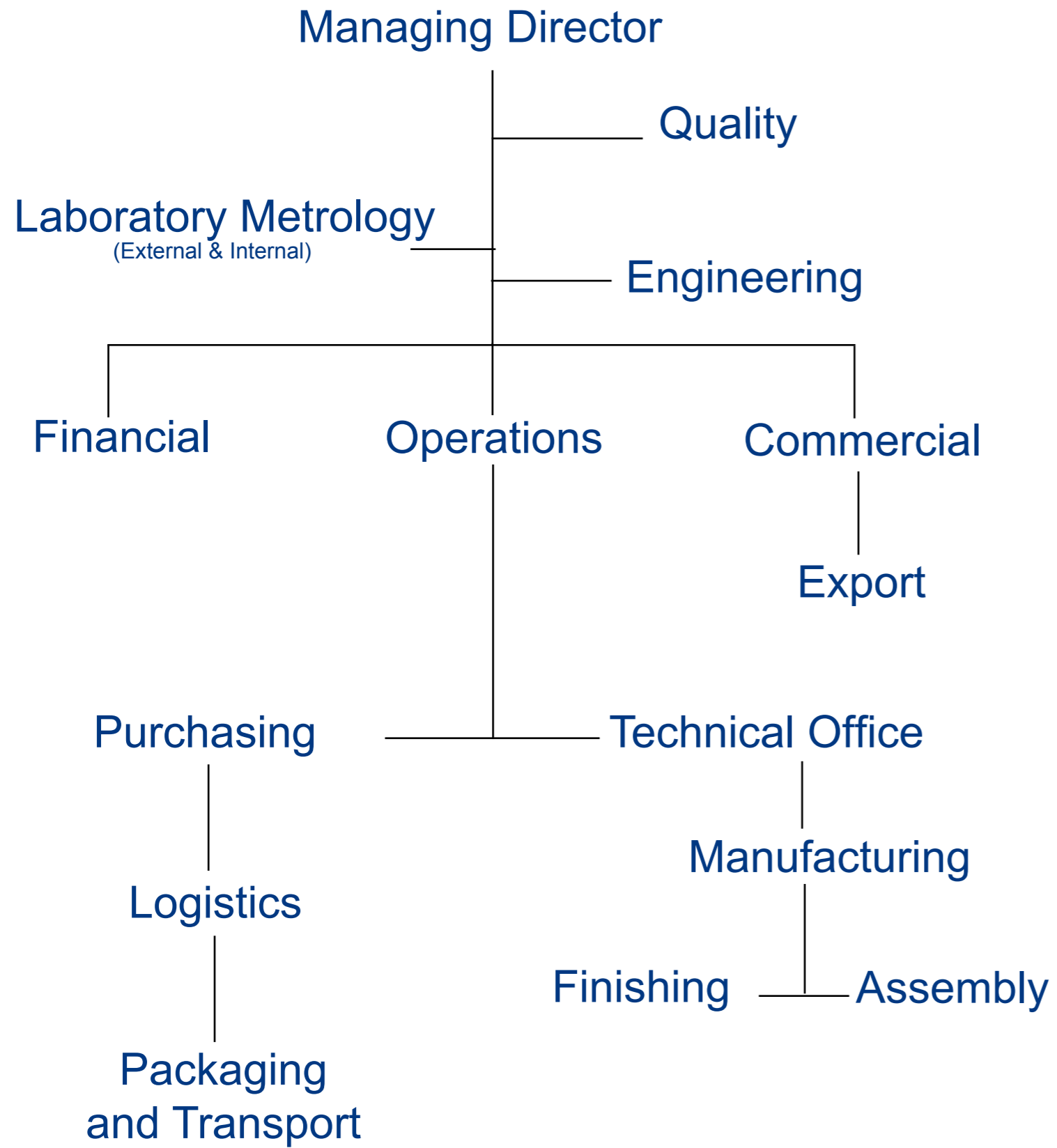

Quality Department

1 Engineer Industrial

Finance Department

1 Finance Director
1 Administration Staff

Commercial Department

1 Commercial Director
1 Export Manager

Purchasing department

1 Global Buyer
1 Subcontracting Buyer

Technical Office

1 Engineer
2 Project Manager
Software: CAD-CAM (VISI-SERIES 14.0)

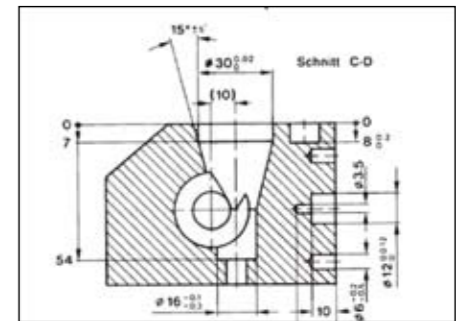
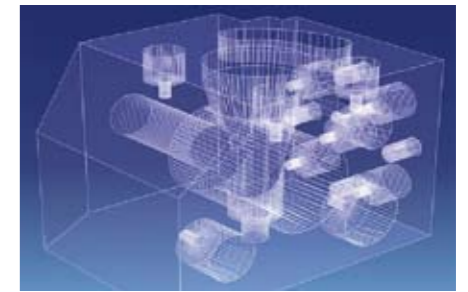

Engineering

Analysis and calculations:

F.E.M. structural analysis, dynamic simulation. Validation and testing of instrumentation.

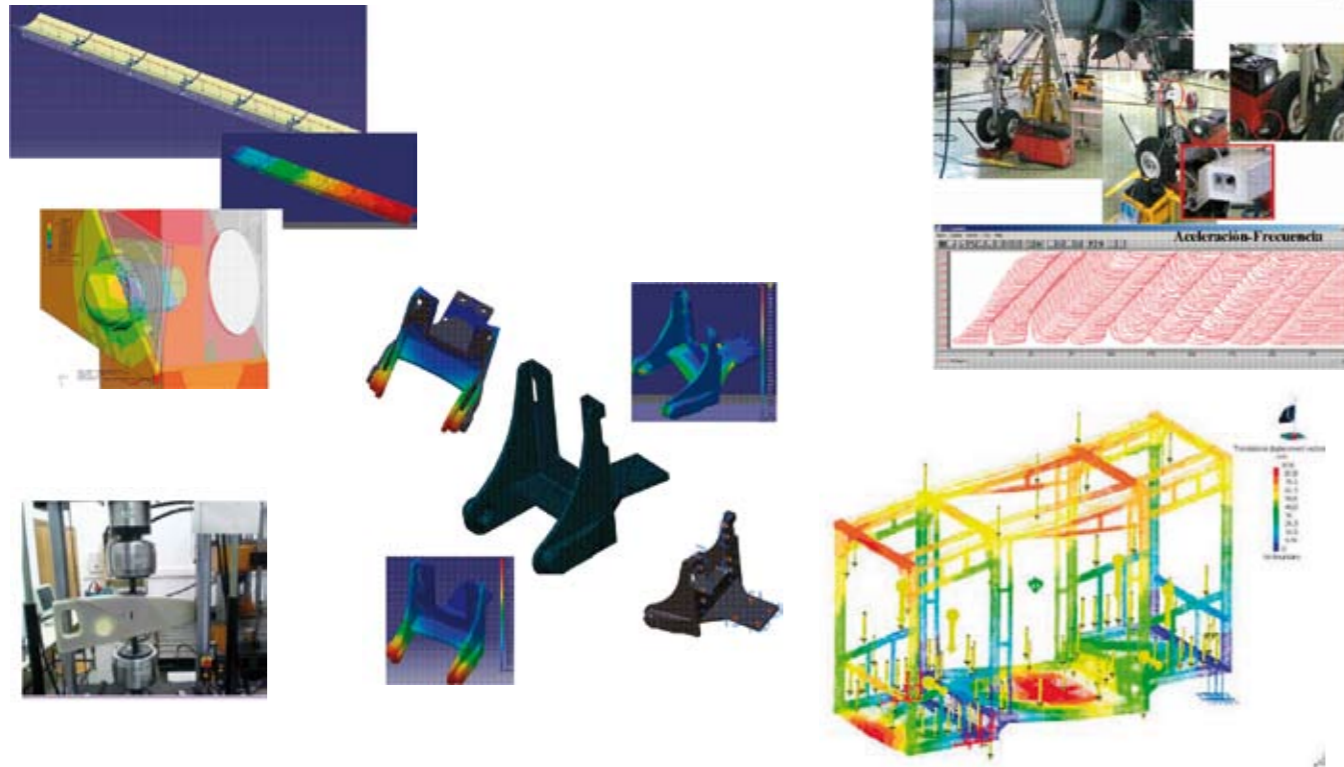

Engineering of Product:

Design and development of mechanical projects. Design in plastic and composite material.

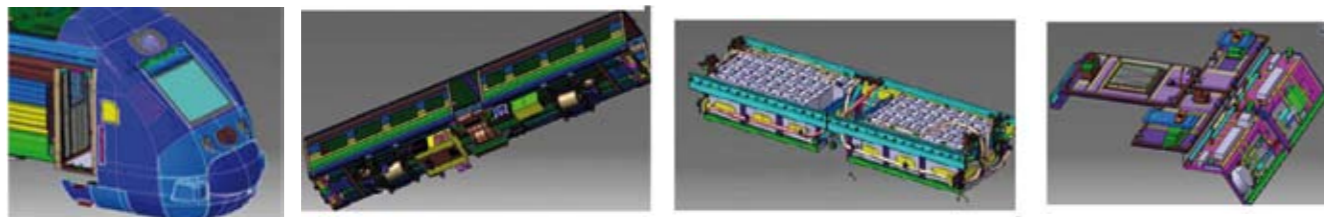
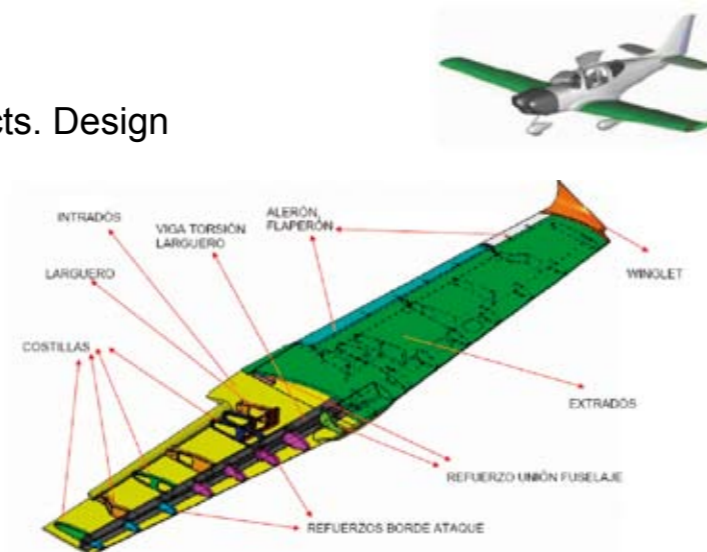
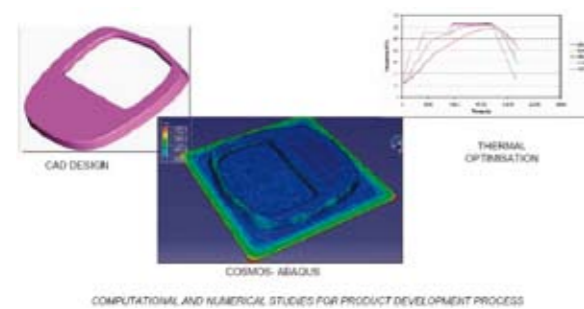

Engineering of Production:

Design and manufacturing of production tools, machines, assembly lines, control calipers, etc.

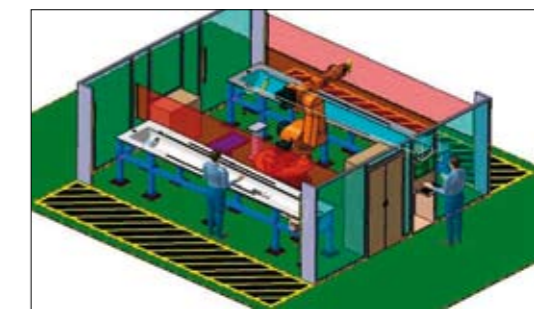
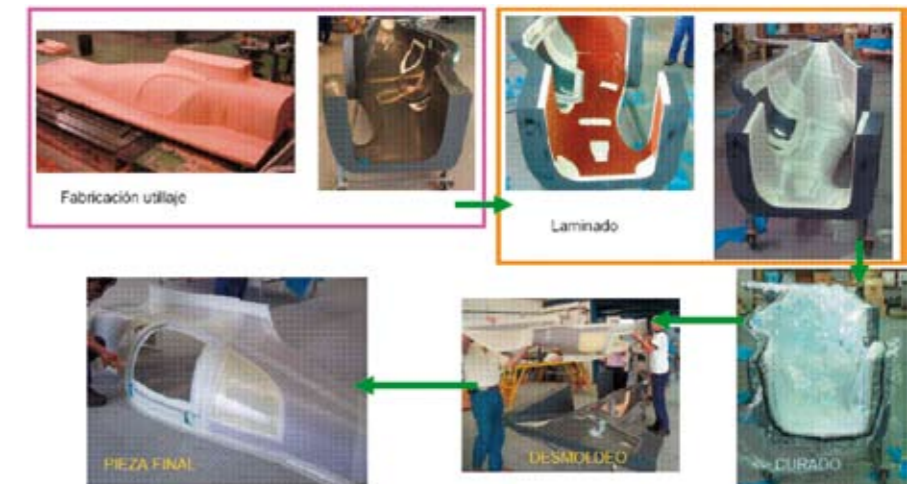
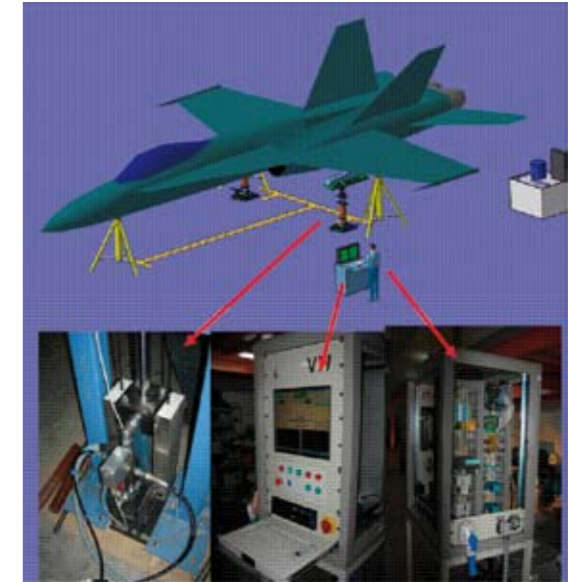

SOFTWARE:

- CATIA V5,
- PROENGINEER
- UNIGRAPHICS
- SOLIDWORK
- SOLIDEDGE
- INVENTOR AUTOCAD
- ABAQUS
- MSC LAMINATE
- ADAMS
- DYTRAN
- LS-DYNA
- NASTRAN-PATRAN

Laboratory Metrology

- Staff with certification in AUKOM
- Industrial Engineer
- Quality Controller
- Measuring and Precision equipment:

- * Coordinate measuring machine for scanning technology. ZEISS CONTURA G2 (700 x 1000 x 600 mm)
- * Coordinate Measuring BROWN & SHARPE (400 X 500 X 300 mm)
- * Vertical column TRIMOS (600 mm)
- * Vertical column TESA (600 mm)
- * Vertical column MANSER (400 mm).
- * Sour face Roughness testers.
- * Hardness tester HB, HRC, HS.
- * Profile Projectors.
- * Electromagnetic Crack Detection Test Bench
- * Metrotomography®, Measuring and Inspection Internal by X-RAY (Computer Tomography).



Metrotomography®

Measuring and analysis of internal geometry by X-Ray (Computer Tomography)

Non-destructive analysis of porosity, inclusions and blow holes, assembly checking and internal geometry view.

Complete measuring and comparison to CAD-solid (CAD/actual comparison).

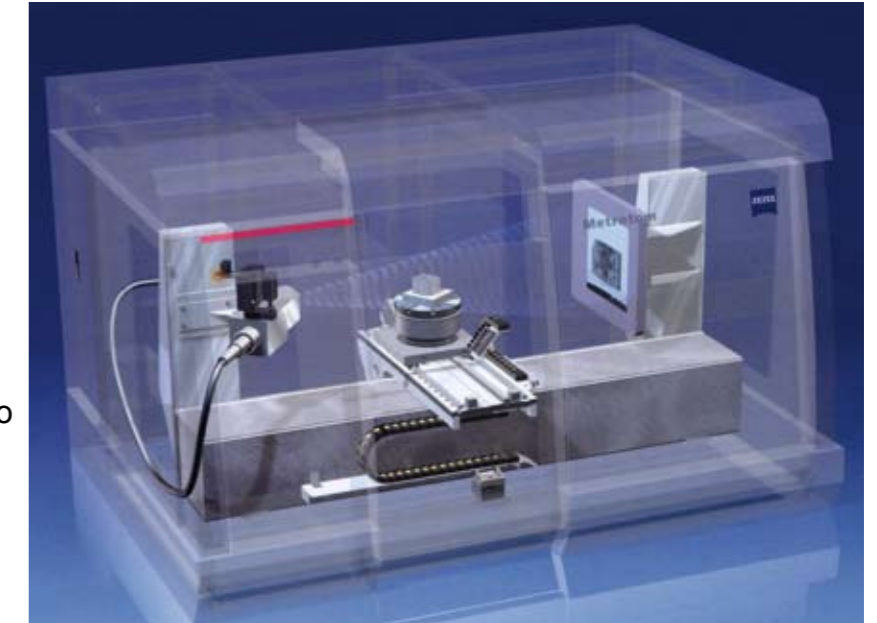

Porosity analysis



CAD/actual comparison

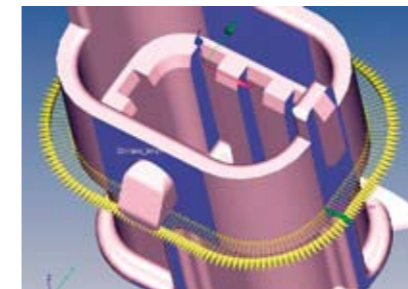

Measuring of geometry

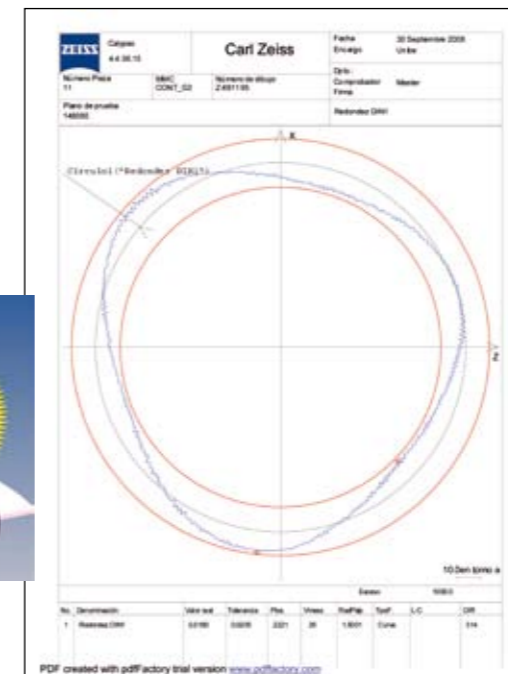

ZEISS Calypso					
Value real	Value nom.	Tol. sup.	Tol. inf.	Deviation	
38.1571	38.0000	0.1000	0.0000	0.0071	
62.9537	63.0000	0.0000	-0.1000	-0.0463	
62.9570	63.0000	0.0000	-0.1000	-0.0430	
-3.5496	-3.5000	0.0000	-0.0000	0.0194	
-0.3417	-0.3000	0.0000	-0.0000	0.0193	
28.8986	28.9000	0.1000	-0.1000	-0.0102	
28.8930	28.9000	0.1000	-0.1000	-0.0070	
65.7228	65.0000	0.5000	-0.5000	0.7228	
0.0194	0.0000	0.0000	0.0000	0.0194	
47.2052	46.8000	0.1000	-0.2000	0.2052	

Results



Machining

Departament

Multitask center



OKUMA MULTUS B 300

15kW ø630 x 900mm
15kW 630 x 230 x 900 mm

Cnc lathes



1 **BIGLIA B111**
7,5 kW ø250 x 350 mm

1 **OKUMA LB 15**
9 kW ø300 x 300 mm

1 **MORISEIKI SL 25**
11,5 kW ø350 x 500 mm

1 **OKUMA LB 300 M**
15 kW ø370 x 500

Horizontal & Vertical center



1 **DECKEL-MAHO DMC 50-V.**
15kW; 20 m/s; 650 x 400 x 450 mm.

1 **VICTOR VCENTER 70.**
11,5kW; 32 m/s; 760 x 440 x 450 mm.

2 **OKUMA MF 46V.**
17,5kW; 60 m/s; 760 x 440 x 450 mm

2 **QUASER 60-II.**
11,5kW; 32 m/s; 500 x 500 mm.

1 **OKUMA 50 HB.**
22kW 60 m/s; 500 x 500 mm.

1 **OKUMA MA 400.**
22kW 60 m/s; 500 x 500 mm.

Grinding machine



1 **Surface HIDROPREC RSP 800**
1000 x 500 x 500 mm

1 **Cylinder DANOBAT U500**
ø 300 x 500 mm

1 **Cylinder PRECISSORI CNC 1000**
ø 300 x 1000 mm

Cutting machine



MISSLER DEB 410 CE
Automatic CNC Cutting
Power 15 kw
ø 410 mm



Surface treatment

Assembly



- 2 Vibratory bowls
- 2 Blast cabinets
- 1 Cabinet washers
- 1 Electro polishing
- 1 Industrial washing machine
- Packaging area

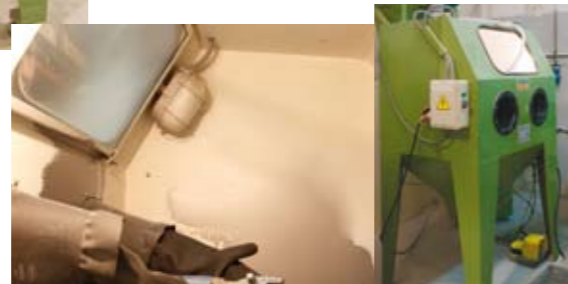

IberPrecis S.L.

Polígono Pignatelli, nave 17

E-50410 Cuarte de Huerva

Tel: +34 976 503 727

Fax: +34 976 503 728

iberprecis@iberprecis.com

Zaragoza (España)



www.iberprecis.com